

# Self-Guided Campus Tour

- 1 University Hall
- 2 Kuhlin Center
- 3 McFall Center
- 4 Founders Hall
- 5 Alumni Gateway
- 6 Prout Chapel
- 7 Seal/Bowen-Thompson Quadrangle
- 8 Bowen-Thompson Student Union
- 9 Oaks Dining Hall
- 10 Science Corridor
- 11 McDonald Residence Hall
- 12 Offenhauer Towers
- 13 Bureau of Criminal Investigation
- 14 College of Technology, Architecture and Applied Engineering
- 15 Accessibility Services
- 16 Kokosing Hall
- 17 BGSU Flight Center
- 18 Education Building
- 19 Central Hall
- 20 Olscamp Hall
- 21 Oak Grove Cemetery
- 22 Health and Human Services
- 23 Moore Musical Arts Center
- 24 Student Recreation Center
- 25 BGSU Athletics
- 26 Kreischer Quadrangle
- 27 Wolfe Center for the Arts
- 28 Fine Arts Center
- 29 Memorial Hall
- 30 Jerome Library
- 31 Greek Housing
- 32 Centennial Hall
- 33 Conklin Hall
- 34 Carillon Place
- 35 Kohl Hall
- 36 Falcon Health Center
- 37 Schmidhorst College of Business – Maurer Center
- 38 Moseley Hall





Welcome to our beautiful campus nestled in small-town Bowling Green, Ohio.

The Wall Street Journal consistently ranks BGSU among the top public universities in the Midwest students would choose again.

There's no better way to decide if a school is the right fit than to visit and explore. With this map as your guide, you're able to do just that!



#### University Hall

Our oldest building on campus, University Hall was renovated in 2017 with careful attention to preserve many of its original features, including the marble staircase. University Hall is one of the most photographed spaces on campus, with many students celebrating their graduation at the grand entrance. Dreams are followed and lives are changed in University Hall.



#### Kuhlín Center

Home to the School of Media and Communication, the Kuhlín Center features high-tech active classrooms, collaboration spaces, labs and some of the very best audio and visual production facilities in the nation.



#### McFall Center

Originally built in 1927 to be the University Library, this now houses the BGSU Graduate College, the University President's Office and Student Affairs.



#### Founders Hall

This suite-style residence hall houses the Honors College and Honors Learning Community and provides all-gender housing options for interested students.

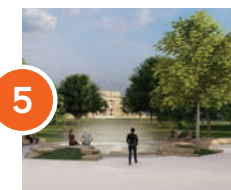

#### Alumni Gateway

The Alumni Gateway is a sprawling green space where students can study, socialize and relax. The Schmeltz Family Fountain is the centerpiece of this lovely, park-like setting.



#### Prout Chapel

Built in 1951, Prout Chapel has now become a popular venue for the wedding ceremonies of couples who met at the university, commonly referred to as "Falcon Flames."

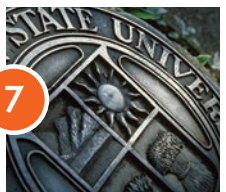

#### Seal/Bowen-Thompson Quadrangle

The official University seal was designed by Leon Winslow in 1914 to follow the format of the State Seal of Ohio. One of the myths that goes along with the seal is "If you stand on the seal and kiss your sweetheart at midnight, under a full moon, you'll soon be married."



#### Bowen-Thompson Student Union

Known as the "heart of campus," the Student Union is one of the most popular spots for students. The Student Union is home to a dining area called the Falcon's Nest, Pub 1910, and Northwest Ohio's most popular Starbucks. It also houses our spirit store Falcon Outfitters, Career Center, Off-Campus Student Lounge, Multicultural Student Center and LGBTQ Resource Center, among other student amenities.



#### Oaks Dining Hall

Our all-you-care-to-eat dining facility features fresh pizza, salad, dessert bars, vegan options and an allergen-free zone that avoids all top allergens. You can also visit our very popular teaching kitchen to learn — or test — your cooking skills.



#### Science Corridor

Here, you'll find spaces dedicated to the sciences — for example, our marine biology lab is housed in the Life Sciences Building, along with lab spaces for forensic science. The Psychology Building offers spaces for conducting research, testing and studies while the planetarium supports the endeavors of our physics and astronomy students.



#### McDonald Residence Hall

This popular first-year student residence hall features traditional double rooms and student lounges for homework, games and other activities. Many students still fondly recall their time in "Mac" many years after graduating.



#### Offenbauer Towers

Home to both first-year and current students, this residence hall features air-conditioned, traditional-style rooms. Bonus: The convenience store inside Offenbauer is handy for a quick snack or toiletry.



#### Bureau of Criminal Investigation

Built in 2014, the Bureau of Criminal Investigation facility provides laboratory and investigative services free of charge to Ohio's criminal justice agencies. This public partnership with the Ohio Attorney General's office brings with it the Center for the Future of Forensic Science, which fosters innovative forensic scientific research and creates training opportunities for forensic professionals and for students in forensic science-related fields.



#### College of Technology, Architecture and Applied Engineering

This building houses academic space for several majors, including engineering, robotics and visual communication technology.



#### Accessibility Services

Located at 38 College Park, Accessibility Services supports the success of students with disabilities by providing opportunities for full integration into the BGSU community. Reach out to this team to discuss possible academic and housing accommodations, documentation needed to apply for services and other resources available to students with disabilities.



#### Kokosing Hall

A renovated and expanded facility for the School of the Built Environment, Kokosing Hall brings the construction management program and the architecture and environmental design program together in an integrated, state-of-the-art facility that provides real-world experiences and prepares students for evolving technology and processes.



#### BGSU Flight Center, 905 E. Poe Road

Since 2014, BGSU and the Bowling Green Flight Center have been in partnership to offer BGSU students quality professional pilot flight training. The Bowling Green Flight Center has constructed over 28,000 square feet of new facilities, purchased new aircraft, and employs over 60 part-time and full-time staff to support the aviation program.



#### Education Building

Here, you'll find the College of Education and Human Development. Some of the majors in this college include: inclusive early childhood, middle childhood education, sport management and interior design. As one of the leading universities for teaching in the country, BGSU was founded as a teaching school in 1910 called Bowling Green Normal College.

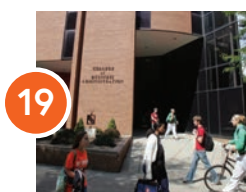

#### Central Hall

Home to general classroom spaces and a computer lab, Central Hall is also the home to the BGSU School of Nursing, including our state-of-the-art nursing skills lab and simulation center.



#### Olscamp Hall

Built in 1994, Olscamp Hall was designed to incorporate modern technology in the classroom. The building is named after former BGSU president, Paul J. Olscamp who wanted students of all majors to come together.



#### Oak Grove Cemetery

Oak Grove Cemetery has been located on this plot of land since the middle of the 19th century. When BGSU was first founded in 1910, the campus was contained to "Old Campus" (where University Hall is located.) When the University grew and expanded out to the cemetery, rather than moving everything, the University decided to put up a fence around the cemetery and build around it.



#### Health and Human Services

Originally built in 1942 as the student health center, Health and Human Services underwent major renovations in 2013 and now houses the College of Health and Human Services, which includes majors in criminal justice, communication sciences and disorders, gerontology and social work.



#### Moore Musical Arts Center

The Moore Musical Arts Center is home to our College of Musical Arts. Fun fact - if you were to hop in an airplane over at our Wood County Airport and fly over top of this building, it is going to look like a baby grand piano from above. In this building, students have access to over 88 practice rooms to represent the 88 keys on the piano.



#### Student Recreation Center

Renovated in 2014, the Student Recreation Center is commonly referred to as "the Rec." Highlights include an Olympic-sized pool; rooms for GroupX class such as yoga and spinning; and courts for racquetball. Full-time BGSU students can come to the Rec and work out for free.



#### BGSU Athletics

BGSU is a Division I athletic school with many Division I sports. With a strong fan following, BGSU is also great for any student who wants to stay active with our club and intramural sport offerings, many of which are competitive and travel to compete against other universities. Go Falcons!



#### Kreischer Quadrangle

Traditional residence hall with double rooms and community restrooms in each wing, Kreischer is the only residence hall with a dining facility right inside the building!



#### Wolfe Center for the Arts

The Wolfe Center boasts creative spaces for the Department of Theatre and Film and houses digital arts labs, two theaters, rehearsal halls, a costume shop and a scene shop. This building was notably designed by the internationally renowned architectural firm that also built the 9/11 Memorial Museum Pavilion in NYC.



#### Fine Arts Center

The Fine Arts Center houses three galleries for art showings, glass blowing facility, graphic design computer lab and jewelry, ceramics and photography labs. BGSU's School of Art is the largest public art school in Ohio.



#### Memorial Hall

Here, you'll find the Army and Air Force ROTC Programs as well as the BGSU Gymnastics Team.



#### Jerome Library

Eight floors of resources are nestled in our uniquely designed Jerome Library. The floors include a tutoring center called The Learning Commons, the FLY (Falcon Learning Your Way) Program, a research and information desk, a hands-on creative space for students, a music library, the Browne Popular Culture Library and plenty of other archives to be immersed in.

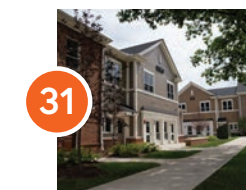

#### Greek Housing

Opened Fall 2016, the Greek Village features traditional townhome-style residences and includes 10 buildings with 33 individual units for many chapters. The community is designed like an urban village with quadrangles, interior walkways and gathering spaces.

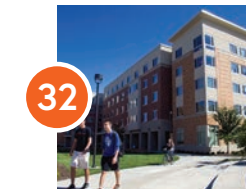

#### Centennial Hall

Opened in 2011, this first-year student residence hall is suite-style with privately shared bathrooms. The hall contains a computer lab, lounge areas, kitchen and laundry facilities.

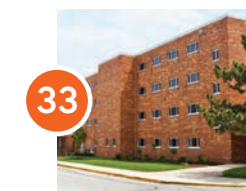

#### Conklin Hall

One of our smaller residence halls, Conklin Hall is a traditional-style hall, centrally located on campus.

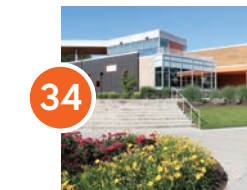

#### Carillon Place

The Carillon Place is a dining hall on campus with dine-in and to-go options, including a pizza and pasta bar, sweets and treats, burritos, grilled favorites, Mediterranean food, and premium features. Students also enjoy the market convenience store inside to stock up on snacks.

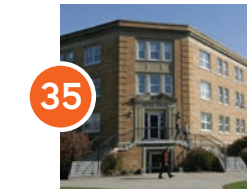

#### Kohl Hall

Primarily for first-year students, Kohl Hall is home to several learning communities, which allow students to live among classmates with similar interests — service, leadership and community involvement, for example.



#### Falcon Health Center

The Falcon Health Center serves the surrounding community as well as BGSU faculty, staff and students. It offers a wide range of services including appointments with medical providers, immunizations, lab and radiology services and a full-service pharmacy with drive-through (just to name a few!)

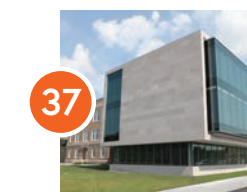

#### Schmidthorst College of Business – Maurer Center

With stunning architecture and state-of-the-art technology, the Robert W. and Patricia A. Maurer Center is among one of the most modern and innovative learning environments for business education in the nation. The building, which is home to the Allen W. and Carol M. Schmidthorst College of Business, includes high-concept, high-tech learning facilities to encourage active collaboration for future business leaders and entrepreneurs.

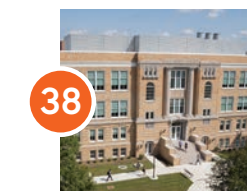

#### Moseley Hall

This recently-renovated academic space allows students to participate in classroom and lab courses in flexible and collaborative spaces that support innovative, research-driven approaches to science teaching and learning.



And don't forget to stop by our BGSU letters in our Union Oval — you won't miss them!

#### Freddie and Frieda

If you see our famous Falcon mascots, don't be shy, be sure to say hi to our fine feathered friends and have your picture taken with them.

If you would like more information or have questions, please call the Office of Admissions at 419-372-2478 or [choosebgsu@bgsu.edu](mailto:choosebgsu@bgsu.edu)

